

CHAINS

ESTABLISHED CORNERS FOR OREGON STATE BOARD OF FORESTRY

South West One Sixteenth corner for Section 6,
T. 2 N, R. 9W, W.M., Tillamook County, Oregon

ESTABLISHED

Var. 21 1/2 E

Set 1 1/2" x 36" galvanized iron pipe with 3" bronze cap marked "OREGON STATE BOARD OF FORESTRY SW 1/16 S6 1958 RS401," 33 inches in ground, and from which a:

- 26" Hemlock bears N52E 30.4 ft.; scribed SW 1/16 S6 BT RS401.
- 29" Hemlock bears S7W 37.2 ft.; scribed SW 1/16 S6 BT.

Oregon State Board of Forestry metal location poster on 26" Hemlock BT. Set 4" x 4" x 60" white painted Cedar post 1.5' SE of pipe. Found 1" iron pipe, 6" above ground, N36W 12.1'. (No record found)

Center West One Sixteenth corner for Section 6,
T. 2N, R. 9W, W.M., Tillamook County, Oregon.

ESTABLISHED

Var. 21 1/2 E

Set 1 1/2" x 36" galvanized iron pipe with 3" bronze cap marked "OREGON STATE BOARD OF FORESTRY W 1/16 C--C S6 1958 RS401," 33 inches in ground, in small mound of stone, and from which a:

- 6" Cedar bears N27E 20.4 ft.; scribed CW 1/16 S6 BT.
- 25" Hemlock bears S80W 42.5 ft.; scribed CW 1/16 S6 BT RS401.

Oregon State Board of Forestry metal location poster on 14" Hemlock N67E 3.7 Ft. Set 4" x 4" x 60" white painted Cedar post 1.0' S.W. of pipe.

Dated February 19, 1958

Established by

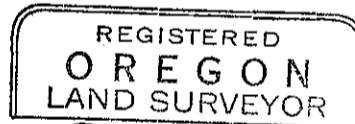

Richard A. Morris

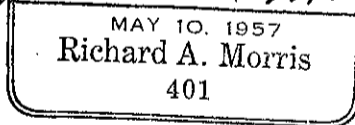

Present and witnessed by Robert Sturm
Harold Russell

Book I

324

324

324